

### SITE PLAN ADDITIONS SUMMARY

BUILDING NUMBER	TOTAL GROSS BUILDING AREA (SF)
BUILDING 37	409,500
BUILDING 35	1,044,000
PROJECT COR BUILDING A	1,603,125
PROJECT COR BUILDING B	1,071,676
BUILDING 32	264,000
BUILDING 31	291,600
BUILDING 25	1,116,000
BUILDING 26A INCREASE	290,700
<b>TOTAL/ AVERAGE</b>	<b>6,090,601</b>

**GENERAL NOTES:**

- EXISTING CONDITIONS INFORMATION HAS BEEN OBTAINED FROM WILL COUNTY GIS VECTOR DATA AND SUPPLEMENTED WITH EXISTING SURVEY DATA WHERE AVAILABLE.

**STORMWATER MANAGEMENT ASSUMPTIONS:**

- ALL COMPENSATORY STORAGE IS ASSUMED TO BE A 1:1 LAND AREA RATIO (COMPENSATORY ALLOCATION/FLOORPLAN) FOR PLANNING PURPOSES. EXISTING FLOODPLAIN IS ZONE "A" AND IS EXTREMELY LIMITED IN ACCURACY. THE ASSUMED COMPENSATORY STORAGE ALLOCATIONS ARE THEREFORE POTENTIALLY INACCURATE. AN EXISTING FLOOD STUDY IS REQUIRED IN ORDER TO VERIFY AND IMPROVE THE ACCURACY OF THE FLOODPLAIN LIMITS.
- DETENTION BASIN "BOUNCE" ASSUMED TO BE 5' IN ALL CASES.
- DETENTION BASIN SIDE SLOPES ASSUMED TO BE 3:1 IN ALL CASES.

**LEGEND**

	EXISTING ROADWAY
	PROPOSED ROADWAY
	PROPOSED TRUCK BARRIER
	PROPOSED LANDSCAPE BUFFER
	EXISTING PIPELINES
	APPROXIMATE LOCATION OF EXISTING ZONE A FLOOD HAZARD AREA
	FLOODPLAIN COMPENSATORY STORAGE BASIN

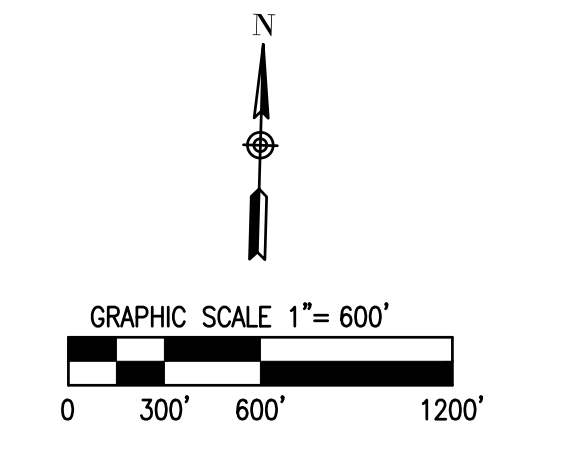
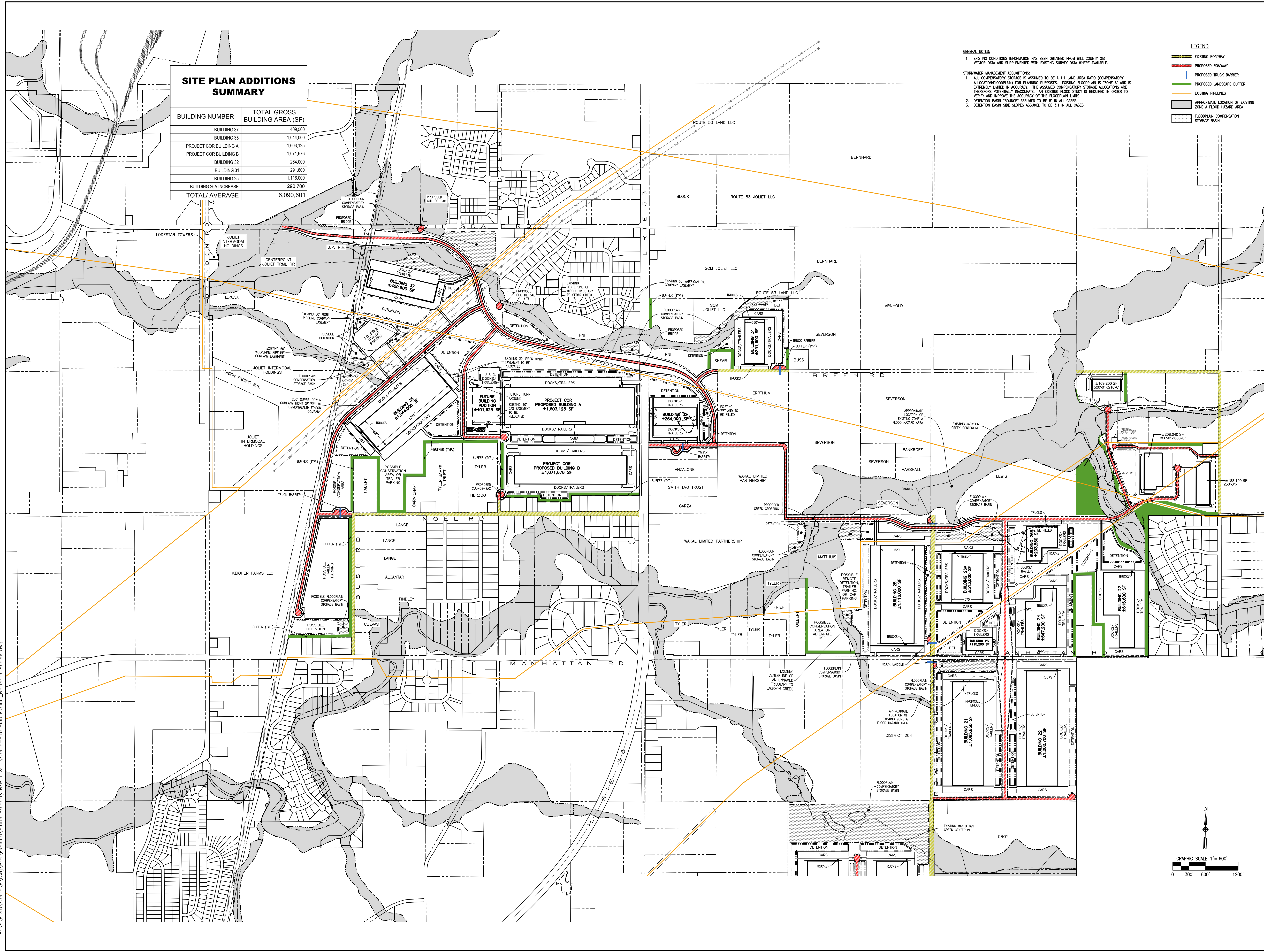

DRAFT CONCEPTUAL SITE PLAN FOR NORTHERN ACCESS PROJECT COR

COMPASS BUSINESS PARK  
NORTHPOINT DEVELOPMENT  
JOLIET, ILLINOIS

**JACOB & HEFNER ASSOCIATES**  
1333 Butterfield Rd, Suite 300, Downers Grove, IL 60515  
PHONE: (630) 652-4000, FAX: (630) 652-4001  
www.jacobandhefner.com



1" = 600'  
F345c  
EXHIBIT

No	Description	Date
1	ORIGINAL EXHIBIT DATE	08/23/21
2	DRAFT	08/30/21

H:\F\45\F345c\Draw\Exhibits\Smith\Plan Exhibit\_Northern\_Access.dwg