

CONCEPT PLAN 1D FOR 4001 BRANDON ROAD @ CIC-J JOLIET, ILLINOIS

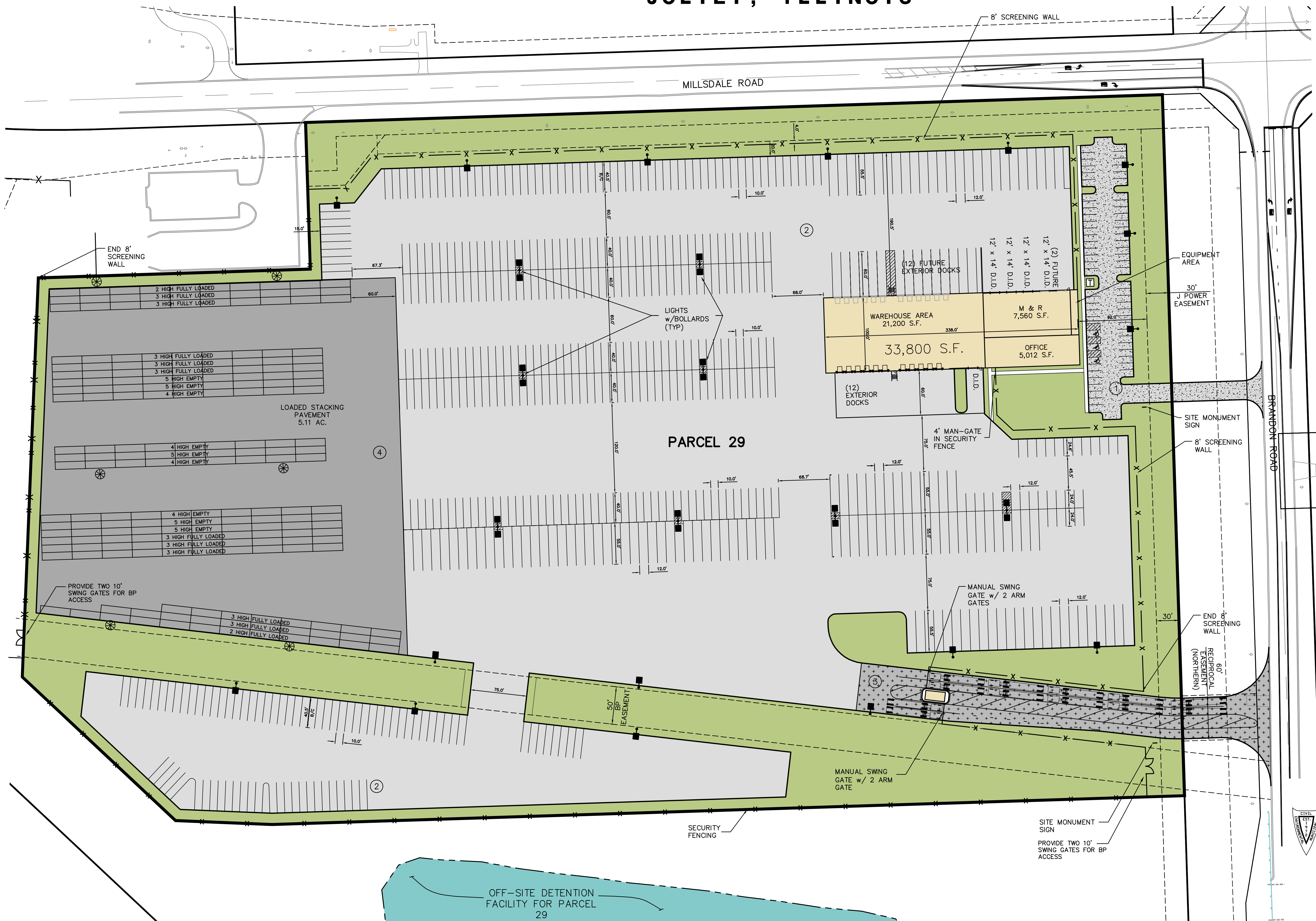

PAVEMENT KEY

- ① 6" P.C.C. PAVEMENT
6" AGG. BASE
UNREINFORCED
- ② 8" P.C.C. PAVEMENT
6" AGG. BASE
UNREINFORCED
- ③ TRUCK ENTRANCE
9" P.C.C. PAVEMENT
6" AGG. BASE
ALL JOINTS REINFORCED
- ④ STACKING AREA
18" JOINTED P.C.C. PAVEMENT
6" AGG. BASE
w/1.5" DOWEL BARS @ 12" CTRS.
ALL JOINTS REINFORCED
CONTROL JOINTS MAX. 12' O.C.

SITE DATA

PARCEL 29 AREA	30.42 Ac.
BP EASEMENT AREA	1.67 Ac.
CONTAINER STACKING PAVEMENT	5.11 Ac.
40' EMPTY CONTAINERS	397
40' LOADED CONTAINERS	338
BUILDING S.F.	33,800 SF.
BUILDING CLEAR HEIGHT	24 FT.
40' x 10' TRAILER PARKING STALLS	387
36' x 10' TRAILER PARKING STALLS	10
55' x 12' TRAILER PARKING STALLS	140
51' x 12' TRAILER PARKING STALLS	5
TRACTOR STALLS	30
DOCK DOORS	12
FUTURE DOCK DOORS	12
D.I.D.	1
12' x 14' D.I.D.	3
FUTURE 12' x 14' D.I.D.	2
AUTO PARKING	65



CenterPoint Properties

PREPARED FOR:
CENTERPOINT PROPERTIES
1808 SWIFT DRIVE
OAKBROOK, ILLINOIS 60523
(630)586-8000

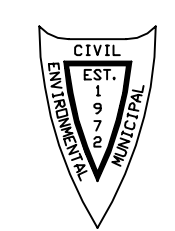

PREPARED BY:
CEMCON, Ltd.

Consulting Engineers, Land Surveyors & Planners
2280 White Oak Circle, Suite 100
Aurora, Illinois 60502-9675
PH: 630.862.2100 FAX: 630.862.2199
E-Mail: cadd@cemcon.com Website: www.cemcon.com

DISC NO.: 731013 FILE NAME: 2023-10-06 CONCEPT CONT BERM 1D
DRAWN BY: KMS FLD. BK. / PG. NO.: -----
COMPLETION DATE: 10-06-23 JOB NO.: 731.013
XREF: PROJECT MANAGER: MMW

PLOT FILE CREATED: 10/06/2023 BY: KRISTIN STARKEL DRAWING PATH: P:\231013\DWG\ENGR\DRAWINGS\CONCEPT\01_01_24 BRANDON & MILLSDALE\2023-10-06 CONCEPT CONTAINER WALL 1D.DWG